

SMART FIXATION

ALFA System - Cranial options

“Smart in Fixation.”





TABLE OF CONTENT

Introduction	4
System and features	6
Bone screw	8
Bone plate	8
Instruments	16
Container	20

ALFA-system Cranial options

Who are we?

Our Company

Titimed specializes in standardized cranio-maxillofacial (CMF) solutions. We have over 40 years of experience in the design, development and manufacturing of superior, innovative, **high quality** and user-friendly CMF products. This has been accomplished with the cooperation, experience and commitment of outstanding cranio-maxillofacial surgeons from leading clinics.

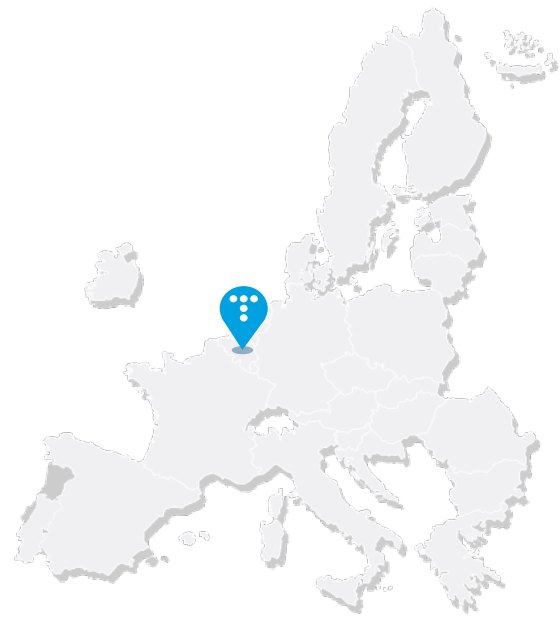

Location

We are based in Belgium, the heart of Europe, with its excellent reputation in the field of healthcare, biotech and medical devices.

Our products



SMART FIXATION

Smart Fixation is used to provide internal fixation of bones during cranio- and maxillofacial procedures. It offers precise and reliable stabilization, enhancing surgical outcomes.



SMILE DISTRACTION

The palatal distractors are developed to widen the upper jaw, allowing surgeons to deliver outstanding improvements to the facial features of their patients. This innovative solution enhances both functional outcomes and aesthetic appearance.



PERSONALIZED IMPLANTS

For Patient-Specific Implants, Titimed has engaged with strategic partners to provide surgeons with a complete CMF solution. This collaboration ensures enhanced customization, streamlined processes.

ALFA-system Cranial options

Smart in Fixation

Indication

The Cranio ALFA system covers a complete range of plates and screws intended for the cranial skull region:

- ✓ Cranioplasties
- ✓ Craniofacial trauma and reconstruction
- ✓ Craniofacial surgery



Material and Certification





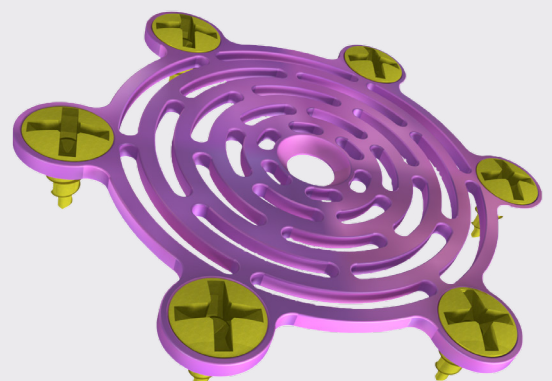

- ✓ Medical grade Titanium
- ✓ MDR and EN ISO 13485 certified material

“Experience the trusted success of SMART fixation!”

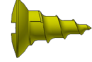
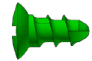

System and features

Overview

Kind	Type	Dimension	Image
ALFA-System Cranial options	Self-drilling	Ø 1.6 mm	
	Self-tapping	Ø 1.6 mm	
	Emergency	Ø 1.9 mm	
ALFA-System Cranial options	Mesh	0.3 / 0.4 mm	
	Bone plates non-reversible	0.5 mm	
0.6 mm			
Screwdriver	Cross pin	-	

Low screw/plate profile

The screw/plate profile is made as low as possible to provide an optimal patient comfort. The perfect balance between a low profile height and superior strength, ensuring an optimal clinical outcome.

Single sided design to facilitate optimal countersinking of screw heads.

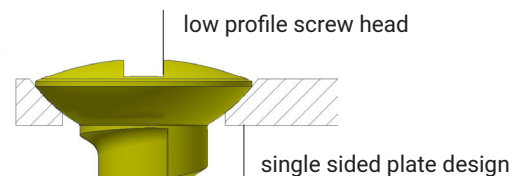

ALFA-system Cranial options

Features

Excellent screw/blade connection

The excellent screw/blade connection contributes to high comfort and ease of use during craniofacial surgeries, ensuring stability and precision throughout the procedure.

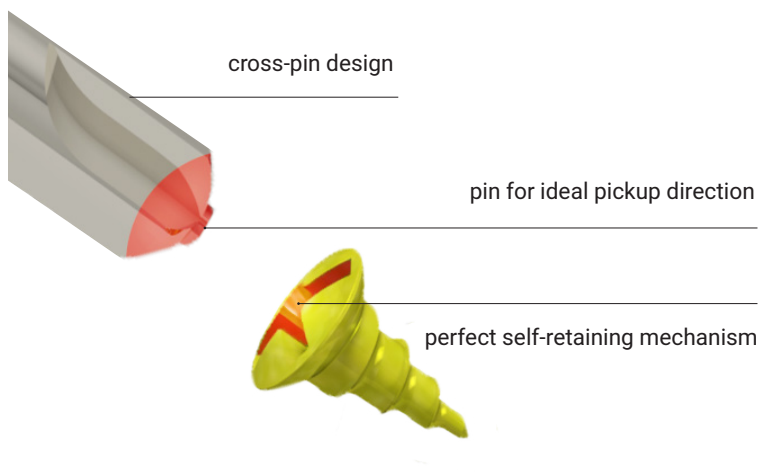

Fast drill free insertion

Both the self-drilling thread design and the tip design contribute to fast and effortless screw insertion. The self-drilling thread design eliminates the need for pre-drilling, while the tip design ensures precise guidance during insertion.

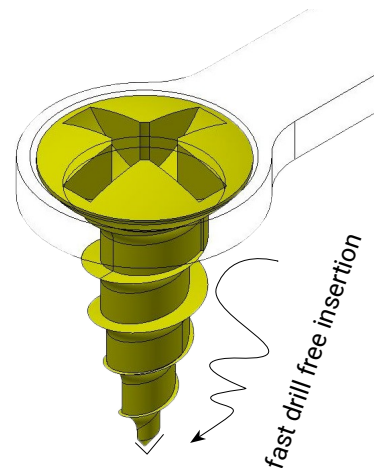

Bone screws

Screw code

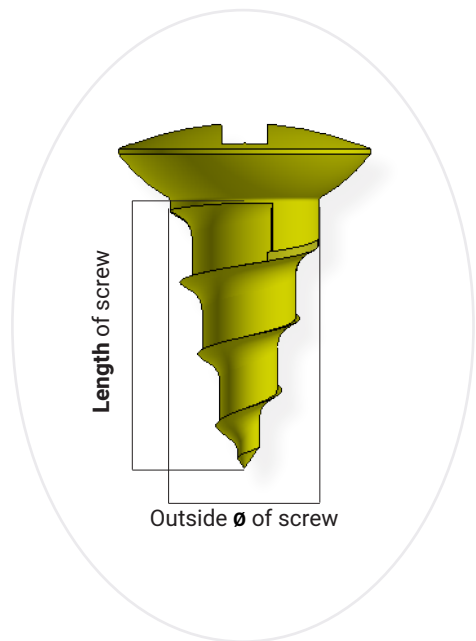
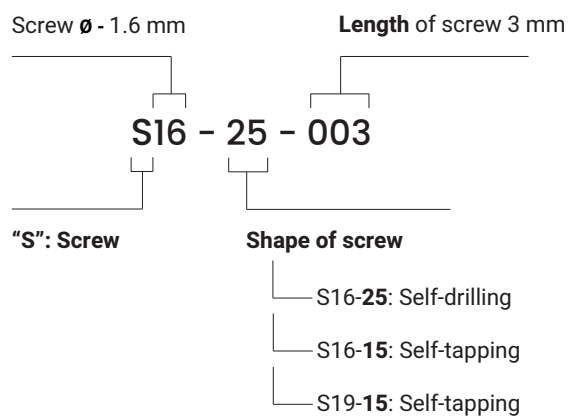

Screw types

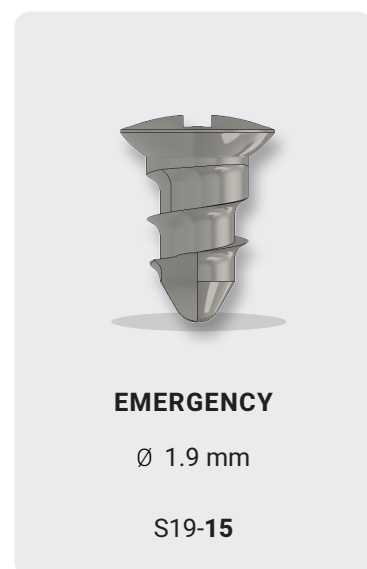
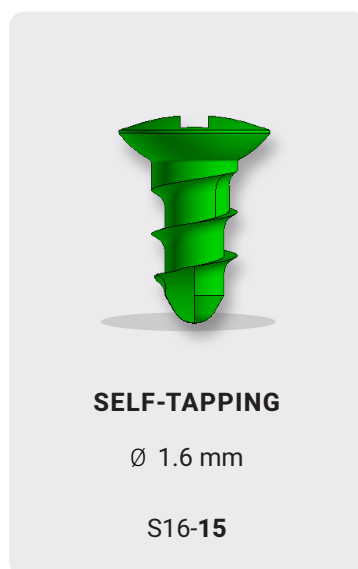
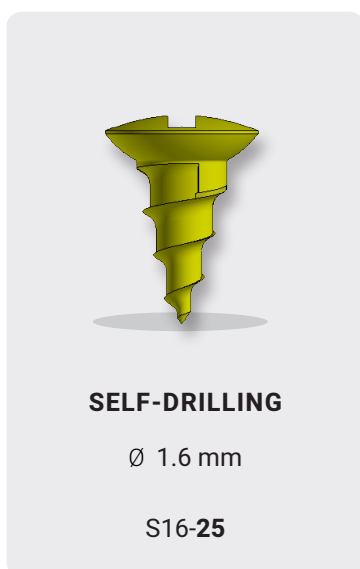

ALFA-system Cranial options

Bone screws

Self-drilling screws 1.6 mm



Cat. No.	Description	Ø	Length
S16-25-003	Bone screw, self-drilling, fast insertion	1.6 mm	3 mm
S16-25-004	Bone screw, self-drilling, fast insertion	1.6 mm	4 mm
S16-25-005	Bone screw, self-drilling, fast insertion	1.6 mm	5 mm

Self-tapping screws 1.6 mm



Cat. No.	Description	Ø	Length
S16-15-003	Bone screw, self-tapping, fast insertion	1.6 mm	3 mm
S16-15-004	Bone screw, self-tapping, fast insertion	1.6 mm	4 mm
S16-15-005	Bone screw, self-tapping, fast insertion	1.6 mm	5 mm

Emergency screws 1.9 mm



Cat. No.	Description	Ø	Length
S19-15-003	Bone screw, self-tapping, fast insertion	1.9 mm	3 mm
S19-15-004	Bone screw, self-tapping, fast insertion	1.9 mm	4 mm
S19-15-005	Bone screw, self-tapping, fast insertion	1.9 mm	5 mm

Bone plates

Bone plate code

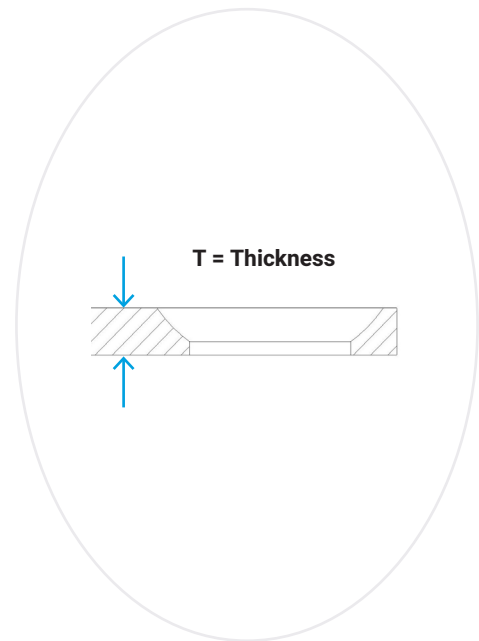
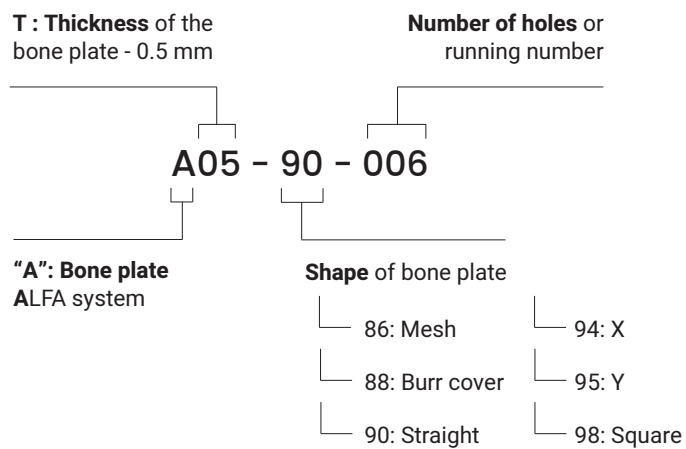

“ Endorsed by numerous cranio and maxillofacial surgeons!

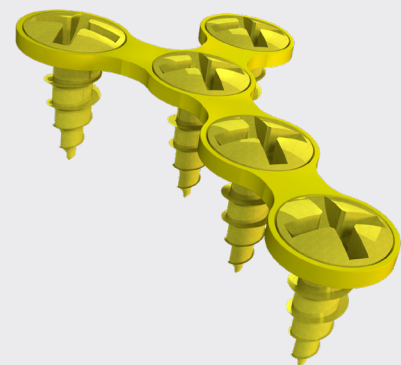

ALFA-system Cranial options

Bone plates

Meshes

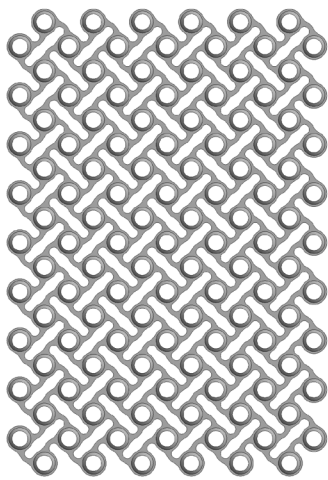

A03-86-001

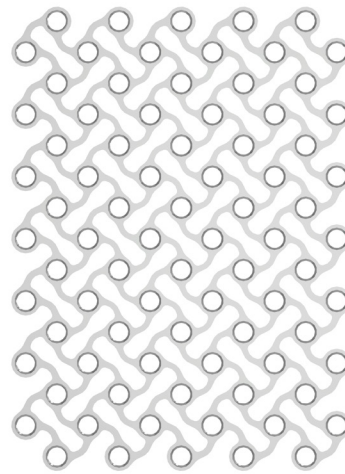

A03-86-082

Cat. No.	Description	Thickness	Cat. No.	Description	Thickness
A03-86-001	dr. DF mesh 38 X 53	0.30 mm	A03-86-082	3D mesh 38 X 53	0.30 mm
A04-86-002	dr. DF mesh 85 X 53	0.40 mm	A03-86-157	3D mesh 75 X 53	0.30 mm
A05-86-002	dr. DF mesh 85 X 53	0.50 mm	A03-86-304	3D mesh 75 x 100	0.30 mm
A05-86-003	dr. DF mesh 85 X 140	0.50 mm	A03-86-420	3D mesh 100 x 100	0.30 mm
			A03-86-684	3D mesh 130 x 130	0.30 mm
			A04-86-082	3D mesh 38 X 53	0.40 mm
			A04-86-157	3D mesh 75 X 53	0.40 mm
			A04-86-304	3D mesh 75 x 100	0.40 mm
			A04-86-420	3D mesh 100 x 100	0.40 mm
			A04-86-684	3D mesh 130 x 130	0.40 mm

Bone plates

Burr covers



A06-88-012

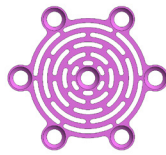

A06-88-015

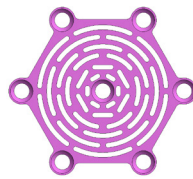

A06-88-018

Cat. No.	Description	Holes	Thickness
A06-88-012	burr cover 12 mm	6	0.6 mm
A06-88-015	burr cover 15 mm	6	0.6 mm
A06-88-018	burr cover 18 mm	6	0.6 mm

“From simple to complex fractures and osteotomies, Smart Fixation delivers versatile solutions for optimal outcomes.



ALFA-system Cranial options

Bone plates

Straight plates



A05-90-102



A06-90-102



A05-90-122



A06-90-122

Cat. No.	Description	Holes	Thickness
A05-90-102	Straight plate	2	0.5 mm
A05-90-122	Straight plate 1+1, 12mm	2	0.5 mm
A06-90-102	Straight plate	2	0.6 mm
A06-90-122	Straight plate 1+1, 12mm	2	0.6 mm



A05-90-104



A06-90-104

Cat. No.	Description	Holes	Thickness
A05-90-104	straight plate 2+2	4	0.5 mm
A06-90-104	straight plate 2+2	4	0.6 mm



A05-90-006



A06-90-006

Cat. No.	Description	Holes	Thickness
A05-90-006	straight plate	6	0.5 mm
A06-90-006	straight plate	6	0.6 mm

ALFA-system Cranial options

Bone plates

Y plates



A05-94-005



A06-94-005

Cat. No.	Description	Holes	Thickness
A05-94-005	Y plate, small	5	0.5 mm
A06-94-005	Y plate small - 3 mm	5	0.6 mm

X plates



A05-95-004



A06-95-004

Cat. No.	Description	Holes	Thickness
A05-95-004	X plate, small	4	0.5 mm
A06-95-004	X plate, small	4	0.6 mm



A05-95-006



A06-95-006

Cat. No.	Description	Holes	Thickness
A05-95-006	X plate, large	6	0.5 mm
A06-95-006	X plate, large	6	0.6 mm

ALFA-system Cranial options

Bone plates

Square plates



A05-98-124



A06-98-124

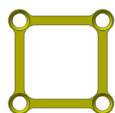

A05-98-154

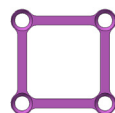

A06-98-154

Cat. No.	Description	Holes	Thickness
A05-98-124	Matrix plate 2x2, 9mm	4	0.5 mm
A06-98-124	Matrix plate 2x2, 9mm	4	0.6 mm
A05-98-154	Matrix plate 2x2, 12mm	4	0.5 mm
A06-98-154	Matrix plate 2x2, 12mm	4	0.6 mm

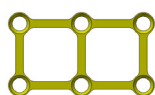

A05-98-126

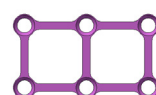

A06-98-126

Cat. No.	Description	Holes	Thickness
A05-98-126	Matrix plate 3x2, 9mm	6	0.5 mm
A06-98-126	Matrix plate 3x2, 9mm	6	0.6 mm

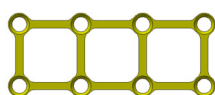

A05-98-128

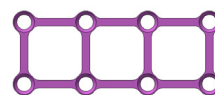

A06-98-128

Cat. No.	Description	Holes	Thickness
A05-98-128	Matrix plate 4x2, 9mm	8	0.5 mm
A06-98-128	Matrix plate 4x2, 9mm	8	0.6 mm

Instruments

Bending and cutting



Cat. No.	Description	Material	Length
IT01-103	Plate bending pliers	stainless steel	160 mm
IT02-201	Plate cutting scissor	stainless steel	160 mm

Plate picking



Cat. No.	Description	Material	Length
IT04-400	Plate holding forceps, straight	stainless steel	152 mm
IT04-401	Plate holding forceps, angled	stainless steel	152 mm

ALFA-system Cranial options

Instruments

Screwdriver

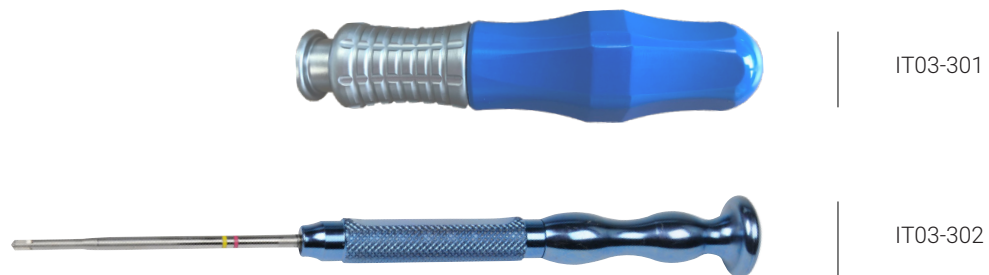

Cat. No.	Description	Material	Length
IT03-301	Handle medium	stainless steel, plastic	100 mm
IT03-302	Cross-pin screwdriver ALFA-BETA	titanium, stainless steel	170 mm

Screwdriver tips

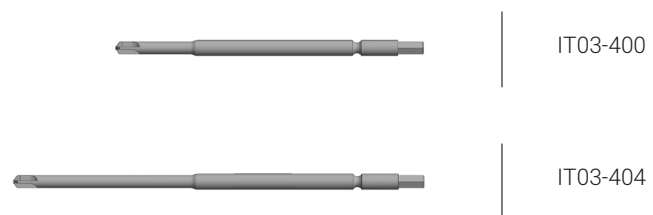

Cat. No.	Description	Material	Length
IT03-400	Screwdriver tip ALFA-BETA, 70mm	stainless steel	70 mm
IT03-404	Screwdriver tip ALFA-BETA, 90mm	stainless steel	90 mm

Instruments

Drills



IT115004



IT115005

Cat. No.	Description	Material	Length
IT115004	Twist drill, Ø 1.1 mm, L=50 mm, stop 4 mm	stainless steel	50 mm
IT115005	Twist drill, Ø 1.1 mm, L=50 mm, stop 5 mm	stainless steel	50 mm

“With over 40 years of expertise, Titamed is a trusted partner in high-quality CMF implants, renowned for its experience in design and manufacturing.

ALFA-system Cranial options

Instruments



ALFA-system Cranial options

Container

SMART Container

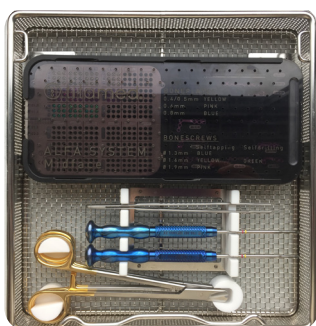

IT10-313

Black box for implants is included in the container IT10-312 and IT10-313. Instruments and implants are not included.

Cat. No.	Description	Material	Length
IT10-312	Container cranio	stainless steel, plastic	240 x 240 mm
Intended for	Cat. No.	Description	Qty
↘	IT01-103	Plate bending pliers	2
↘	IT02-201	Plate cutting scissor	1
↘	IT03-301	Blue handle	2
↘	IT03-400	Screwdriver tip ALFA-BETA	2
↘	IT04-401	Plate holding forceps, angled	1
↘	Twist drills	As per your preference ALFA	-
↘	Implants	As per your preference ALFA	-

Cat. No.	Description	Material	Length
IT10-313	Container cranio	stainless steel, plastic	240 x 240 mm
Intended for	Cat. No.	Description	Qty
↘	IT01-103	Plate bending pliers	2
↘	IT02-201	Plate cutting scissor	1
↘	IT03-302	Screwdriver ALFA-BETA	2
↘	IT04-401	Plate holding forceps, angled	1
↘	Twist drills	As per your preference ALFA	-
↘	Implants	As per your preference ALFA	-

ALFA-system Cranial options

Container

Detail Container



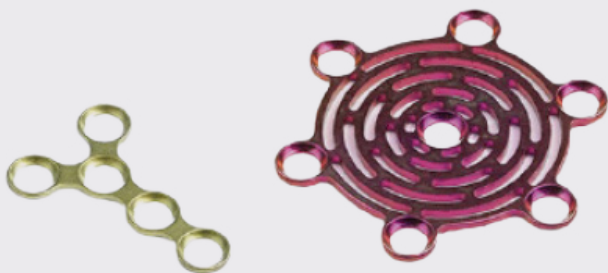

Headquarter

Titamed
Mechelsesteenweg 297 F
2550 Kontich
Belgium

tel: +32 (0)3 289 51 56
email: info@titamed.com
website: www.titamed.com
version: SP-602 Rev. B