

Orthognathic Surgery  
BETA System

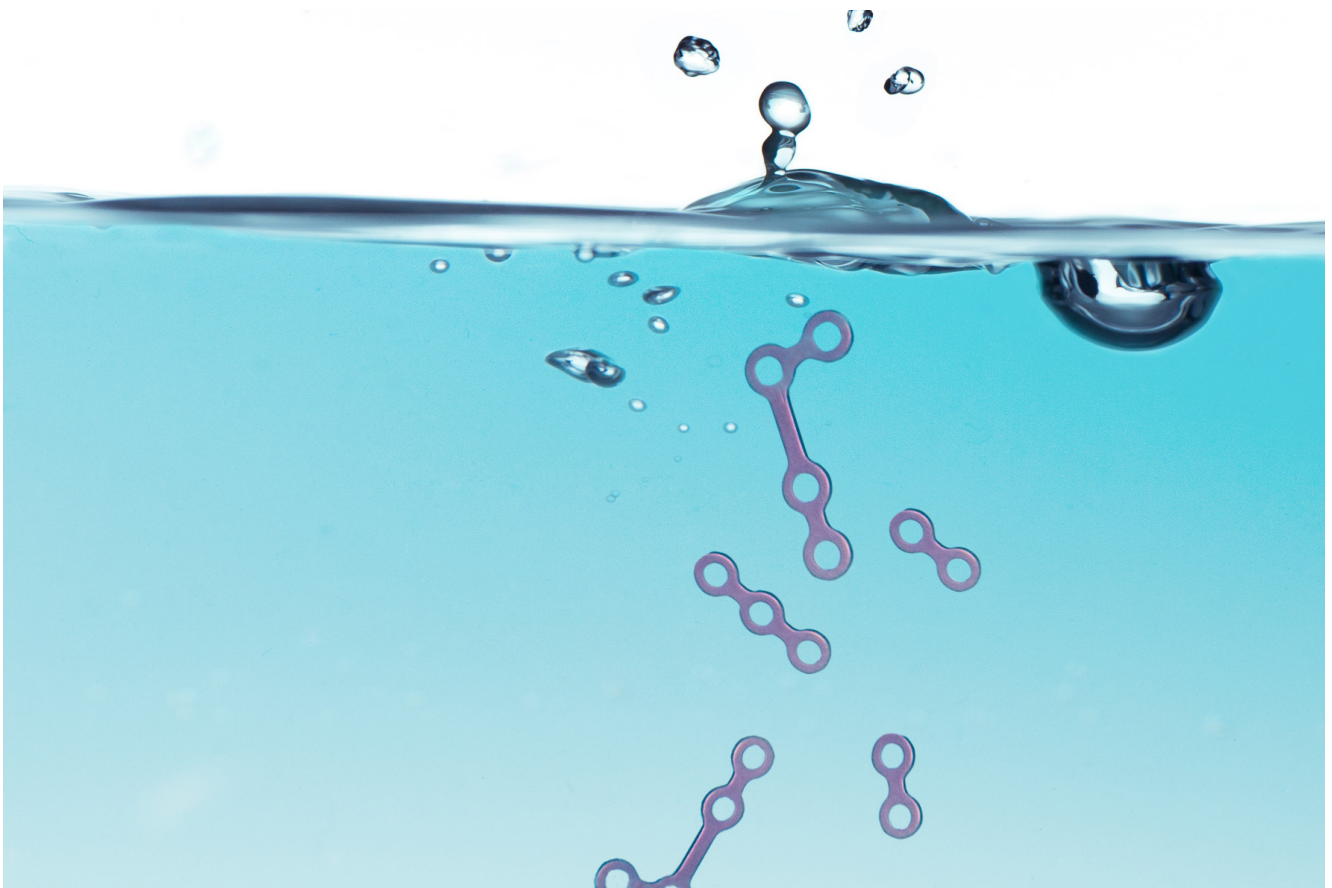



SMART FIX

# BETA System - Orthognatic Surgery

## INTRODUCTION

Titamed's Smart Fixation consists of 3 different systems, each one designed for a specific series of indications:

The ALFA System is a complete range of plates and screws intended for Craniofacial and Midface trauma, including:

- Orbita region
- Frontal sinus area
- Nasal region
- Zygoma region
- Lefort 1 fracture area

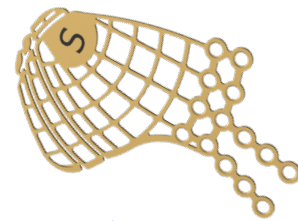

The BETA System is specifically designed for orthognatic surgery:

- Lefort I osteotomy
- Chin osteotomy
- Sagital split osteotomy



The GAMMA System is specifically designed for trauma and reconstructive surgery of the mandible. Simple as well as complex fractures of the mandible can be easily managed with the GAMMA system. All boneplates of the GAMMA system are reversible and compatible with locking and non-locking screws.

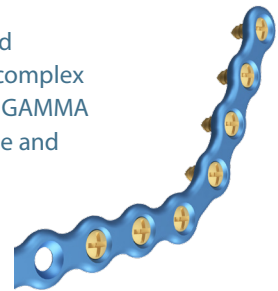

GRADUAL SYSTEM

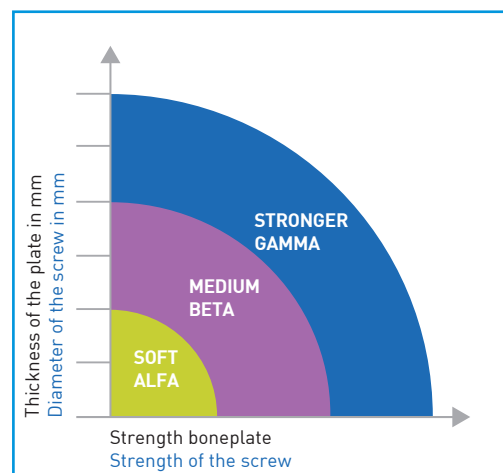

The Smart Fixation is a gradual system.

Color coding per system:

- Yellow: Small screws and plates (ALFA)
- Purple: Medium screws and plates (BETA)
- Blue: Large screws and plates (GAMMA)

# BETA System - Orthognatic Surgery

## INTRODUCTION



Screws, boneplates and instruments of the ALFA and BETA system are interchangeable.

### BONESCREWS

System	Indication	Screw		Specifications
		Selftapping	Selfdrilling	
ALFA	Craniofacial & Midface Trauma	Ø 1.3 mm	-	1 screwdriver for ALFA-BETA
		Ø 1.6 mm	Ø 1.6 mm	
BETA	Orthognatic Surgery	Ø 1.9 mm	Ø 1.9 mm	
		Ø 2.2 mm*	-	
GAMMA	Trauma & Recon of the mandible	Locking	Non-Locking	1 screwdriver for GAMMA
		Ø 2.1 mm	Ø 2.1 mm	
		Ø 2.4 mm	Ø 2.4 mm	
		Ø 2.7 mm	Ø 2.7 mm	

\* Screws of 2.2 mm are not compatible with ALFA-boneplates

### BONEPLATES

System	Indication	Plate		Specifications
		Thickness (mm)		
ALFA	Craniofacial & Midface Trauma	0.3 / 0.4 mm mesh and orbita		Non-reversible**
		0.5 mm		
		0.6 mm		
BETA	Orthognatic Surgery	0.6 mm		Reversible***
		0.7 / 0.8 mm		
		0.8 / 1.0 mm		
GAMMA	Trauma & Recon of the mandible	1.0 mm		Reversible & Locking
		1.3 mm		
		1.5 mm		
		2.0 mm		

\*\* Except for orbita floor plates, they are reversible

\*\*\* Except for the prebent and BSSO plates





INDICATIONS

## BETA System - Orthognatic Surgery

### FEATURES

The BETA System is especially designed for orthognatic surgery:

- Lefort I osteotomy
- Chin osteotomy
- Sagital split osteotomy

This set can be adapted to the wishes of the surgeon:

- Lefort I advancement with (prebent) boneplates
- BSSO with boneplates or/and screws
- Genioplasty with (prebent) plates or screws

GRADUAL SYSTEM

The BETA System is a color coded gradual system:

- Smallest diameter screws and thinnest boneplates: **Yellow**
- Medium diameter screws and medium boneplates: **Purple**
- Large diameter screws and thickest boneplates: **Blue**

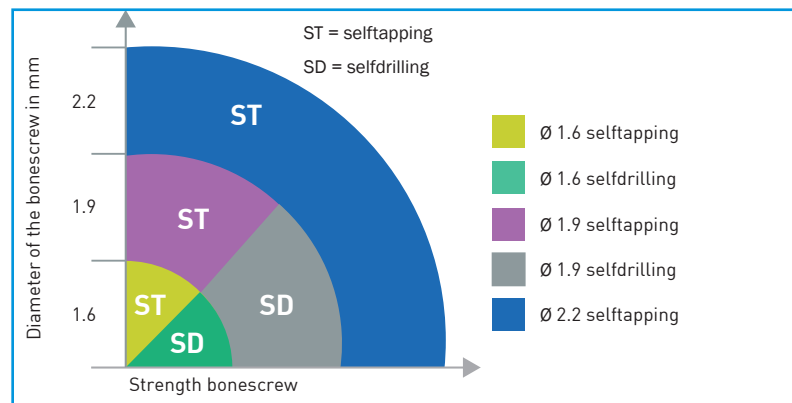
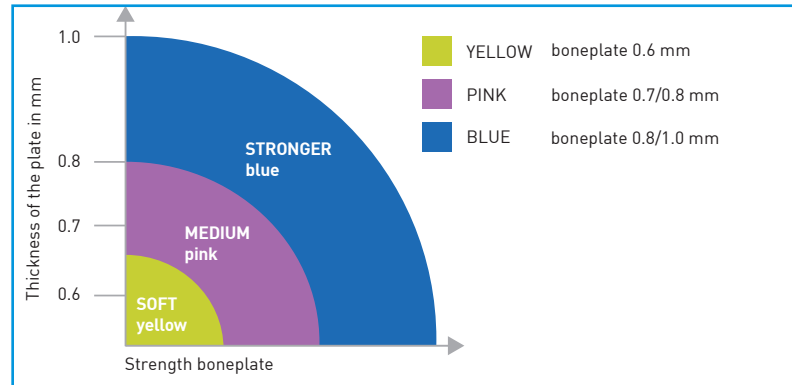

# BETA System - Orthognatic Surgery

## FEATURES

Most boneplates of the BETA System are reversible plates. With this feature the same boneplate can be used on both sides of the patient. This minimizes stock quantities and handling time without compromising choice and variety.

Our large range of boneplates offers an optimal design for each possible indication in the field of orthognatic surgery.

The BETA plates provide a balance of a low profile height and a high strength of the boneplate. The screw/plate interface is made as low as possible to provide an optimal patient comfort.

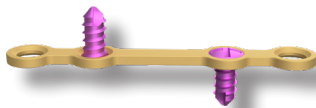

- \* Reversible boneplates
- \* Low screw/plate interface
- \* Optimal balance profile height and strength
- \* Large selection of screws and plates
- \* Medical grade titanium

The surgeon can choose out of different diameters of screws in selfdrilling or selftapping versions. All screws of the BETA system fit into all boneplates of the BETA system.

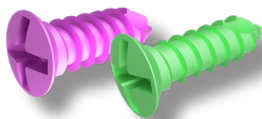

- \* An excellent grip on the bone
- \* Selfdrilling and selftappings screws
- \* Ideal diameters of screws
- \* Longer step for longer screws
- \* Medical grade titanium



## BONEPLATES

## BONESCREWS



## BETA System - Orthognatic Surgery

### BONEPLATES



#### LEFORT BACK



B06-83-010



B06-83-012

Cat. No.	Description	Holes	Thickness	Reversible
B06-83-006	Dr. Defrancq backplate, 6 mm	7	0,6	R
B06-83-008	Dr. Defrancq backplate, 8 mm	7	0,6	R
B06-83-010	Dr. Defrancq backplate, 10 mm	7	0,6	R
B06-83-012	Dr. Defrancq backplate, 12 mm	7	0,6	R

#### PREBENT LEFORT



B08-84-108

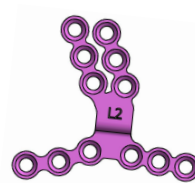

B08-84-008

Cat. No.	Description	Holes	Thickness	Reversible
B08-84-000	prebent lefort plate 0 mm - right	12	0,8	no
B08-84-002	prebent lefort plate 2 mm - right	12	0,8	no
B08-84-004	prebent lefort plate 4 mm - right	12	0,8	no
B08-84-006	prebent lefort plate 6 mm - right	12	0,8	no
B08-84-008	prebent lefort plate 8 mm - right	12	0,8	no
B08-84-010	prebent lefort plate 10 mm - right	12	0,8	no
B08-84-012	prebent lefort plate 12 mm - right	12	0,8	no
B08-84-100	prebent lefort plate 0 mm - left	12	0,8	no
B08-84-102	prebent lefort plate 2 mm - left	12	0,8	no
B08-84-104	prebent lefort plate 4 mm - left	12	0,8	no
B08-84-106	prebent lefort plate 6 mm - left	12	0,8	no
B08-84-108	prebent lefort plate 8 mm - left	12	0,8	no
B08-84-110	prebent lefort plate 10 mm - left	12	0,8	no
B08-84-112	prebent lefort plate 12 mm - left	12	0,8	no

# BETA System - Orthognatic Surgery

## BONEPLATES



### PREBENT CHINPLATE



B08-85-004



B10-85-008

Cat. No.	Description	Holes	Thickness	Reversible
B08-85-003	prebent chinplate, 3 mm	5	0,8	no
B08-85-004	prebent chinplate, 4 mm	5	0,8	no
B08-85-005	prebent chinplate, 5 mm	5	0,8	no
B08-85-006	prebent chinplate, 6 mm	5	0,8	no
B10-85-008	prebent chinplate, 8 mm	5	1,0	no
B10-85-010	prebent chinplate, 10 mm	5	1,0	no



B06-90-003



B07-90-003



B08-90-003



B06-90-004



B07-90-004



B08-90-004

### STRAIGHT PLATES

Cat. No.	Description	Holes	Thickness	Reversible
B06-90-003	straight plate	3	0,6	R
B06-90-004	straight plate	4	0,6	R
B07-90-003	straight plate	3	0,7	R
B07-90-004	straight plate	4	0,7	R
B08-90-003	straight plate	3	0,8	R
B08-90-004	straight plate	4	0,8	R



## BETA System - Orthognatic Surgery

### BONEPLATES



#### STRAIGHT PLATES



B06-90-006



B06-90-008



B07-90-006



B07-90-008



B08-90-006



B08-90-008

Cat. No.	Description	Holes	Thickness	Reversible
B06-90-006	straight plate	6	0,6	R
B07-90-006	straight plate	6	0,7	R
B08-90-006	straight plate	6	0,8	R
B06-90-008	straight plate	8	0,6	R
B07-90-008	straight plate	8	0,7	R
B08-90-008	straight plate	8	0,8	R



B06-90-016



B07-90-016



B08-90-016

Cat. No.	Description	Holes	Thickness	Reversible
B06-90-016	straight plate	16	0,6	R
B07-90-016	straight plate	16	0,7	R
B08-90-016	straight plate	16	0,8	R



# BETA System - Orthognatic Surgery

## BONEPLATES



### STRAIGHT PLATES WITH BRIDGE

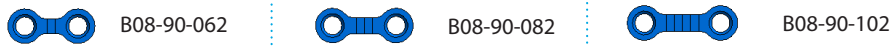

Cat. No.	Description	Holes	Thickness	Reversible
B08-90-062	straight plate	2	0,8	R
B08-90-082	straight plate	2	0,8	R
B08-90-102	straight plate	2	0,8	R



Cat. No.	Description	Holes	Thickness	Reversible
B06-90-104	straight plate 2 + 2	4	0,6	R
B07-90-104	straight plate 2 + 2	4	0,7	R
B08-90-104	straight plate 2 + 2	4	0,8	R
B06-90-106	straight plat 3 + 3	6	0,6	R
B07-90-106	straight plat 3 + 3	6	0,7	R
B08-90-106	straight plat 3 + 3	6	0,8	R



Cat. No.	Description	Holes	Thickness	Reversible
B06-90-908	straight - 8 mm advancement	2	0,6	R
B06-90-910	straight - 10 mm advancement	2	0,6	R



## BETA System - Orthognatic Surgery

### BONEPLATES



#### L PLATES



B06-92-003



B07-92-006



B08-92-010

Cat. No.	Description	Holes	Thickness	Reversible
B06-92-003	L plate - 3 mm	4	0,6	R
B06-92-006	L plate - 6 mm	4	0,6	R
B06-92-010	L plate - 10 mm	4	0,6	R
B07-92-003	L plate - 3 mm	4	0,7	R
B07-92-006	L plate - 6 mm	4	0,7	R
B07-92-010	L plate - 10 mm	4	0,7	R
B08-92-003	L plate - 3 mm	4	0,8	R
B08-92-006	L plate - 6 mm	4	0,8	R
B08-92-010	L plate - 10 mm	4	0,8	R



B06-92-204



B07-92-207



B08-92-211

Cat. No.	Description	Holes	Thickness	Reversible
B06-92-204	Slightly bended L plate - 4 mm	4	0,6	R
B06-92-207	Slightly bended L plate - 7 mm	4	0,6	R
B06-92-211	Slightly bended L plate - 11 mm	4	0,6	R
B07-92-204	Slightly bended L plate - 4 mm	4	0,7	R
B07-92-207	Slightly bended L plate - 7 mm	4	0,7	R
B07-92-211	Slightly bended L plate - 11 mm	4	0,7	R
B08-92-204	Slightly bended L plate - 4 mm	4	0,8	R
B08-92-207	Slightly bended L plate - 7 mm	4	0,8	R
B08-92-211	Slightly bended L plate - 11 mm	4	0,8	R

# BETA System - Orthognatic Surgery

## BONEPLATES



### L PLATES



B06-92-505

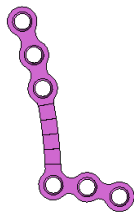

B07-92-509



B08-92-513

Cat. No.	Description	Holes	Thickness	Reversible
B06-92-505	Bended L-plate small- 5 mm	6	0,6	R
B06-92-509	Bended L-plate medium - 9 mm	6	0,6	R
B06-92-513	Bended L-plate large - 13 mm	6	0,6	R
B07-92-505	Bended L-plate small - 5 mm	6	0,7	R
B07-92-509	Bended L-plate medium - 9 mm	6	0,7	R
B07-92-513	Bended L-plate large - 13 mm	6	0,7	R
B08-92-505	Bended L-plate small - 5 mm	6	0,8	R
B08-92-509	Bended L-plate medium - 9 mm	6	0,8	R
B08-92-513	Bended L-plate large - 13 mm	6	0,8	R



B06-94-005



B07-94-005



B08-94-005

### Y PLATES

Cat. No.	Description	Holes	Thickness	Reversible
B06-94-005	Y plate small - 3 mm	5	0,6	R
B07-94-005	Y plate small - 5 mm	5	0,7	R
B08-94-005	Y plate small - 8 mm	5	0,8	R



# BETA System - Orthognatic Surgery

## BONEPLATES



### Y PLATES



B06-94-007

B07-94-007

B08-94-007

Cat. No.	Description	Holes	Thickness	Reversible
B06-94-007	Y plate large - 3 mm	7	0,6	R
B07-94-007	Y plate large - 5 mm	7	0,7	R
B08-94-007	Y plate large - 8 mm	7	0,8	R

### X PLATES



B06-95-006

B07-95-006

B08-95-006

Cat. No.	Description	Holes	Thickness	Reversible
B06-95-006	X plate large - 17 mm	6	0,6	R
B07-95-006	X plate large - 19 mm	6	0,7	R
B08-95-006	X plate large - 21 mm	6	0,8	R



B06-95-004

B07-95-004

B08-95-004

Cat. No.	Description	Holes	Thickness	Reversible
B06-95-004	X plate small - 17 mm	4	0,6	R
B07-95-004	X plate small - 19 mm	4	0,7	R
B08-95-004	X plate small - 21 mm	4	0,8	R

## BETA System - Orthognatic Surgery

### BONEPLATES



B06-96-006



B06-96-008

Cat. No.	Description	Holes	Thickness	Reversible
B06-96-006	Curved plate	6	0,6	R
B06-96-008	Curved plate	8	0,6	R

### CURVED PLATES



B06-98-106



B07-98-106



B08-98-106

Cat. No.	Description	Holes	Thickness	Reversible
B06-98-106	matrix plate medium	6	0,6	R
B07-98-106	matrix plate medium	6	0,7	R
B08-98-106	matrix plate medium	6	0,8	R

### GRID PLATES





BSSO PLATES

# BETA System - Orthognatic Surgery

## BONEPLATES

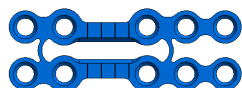

B10-99-205

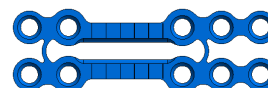

B10-99-209

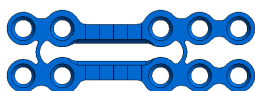

B10-99-207

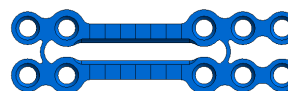

B10-99-213

Cat. No.	Description	Holes	Thickness	Reversible
B10-99-205	double row bssso plate, 5 mm	10	1,0	no
B10-99-207	double row bssso plate, 7 mm	10	1,0	no
B10-99-209	double row bssso plate, 9 mm	10	1,0	no
B10-99-213	double row bssso plate, 13 mm	10	1,0	no



B10-99-004



B10-99-010



B10-99-006



B10-99-012



B10-99-008

Cat. No.	Description	Holes	Thickness	Reversible
B10-99-004	single row bssso plate, 4 mm	4	1,0	no
B10-99-006	single row bssso plate, 6 mm	4	1,0	no
B10-99-008	single row bssso plate, 8 mm	4	1,0	no
B10-99-010	single row bssso plate, 10 mm	4	1,0	no
B10-99-012	single row bssso plate, 12 mm	4	1,0	no



B10-99-103



B10-99-104



B10-99-105

Cat. No.	Description	Holes	Thickness	Reversible
B10-99-103	single row bssso plate, 7 mm	4	1,0	no
B10-99-104	single row bssso plate, 9 mm	6	1,0	no
B10-99-105	single row bssso plate, 12 mm	6	1,0	no

# BETA System - Orthognatic Surgery

## BONESCROWS



Cat. No.	Description	Length
S16-10-003	cross-pin bonescrew, selftapping	3
S16-10-004	cross-pin bonescrew, selftapping	4
S16-10-005	cross-pin bonescrew, selftapping	5
S16-10-006	cross-pin bonescrew, selftapping	6
S16-10-008	cross-pin bonescrew, selftapping	8
S16-10-010	cross-pin bonescrew, selftapping	10
S16-10-012	cross-pin bonescrew, selftapping	12
S16-10-014	cross-pin bonescrew, selftapping	14
S16-10-016	cross-pin bonescrew, selftapping	16

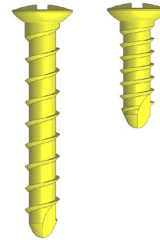

1.6 MM SCREW  
SELFTAPPING

Cat. No.	Description	Length
S19-10-004	cross-pin bonescrew, selftapping	4
S19-10-005	cross-pin bonescrew, selftapping	5
S19-10-006	cross-pin bonescrew, selftapping	6
S19-10-008	cross-pin bonescrew, selftapping	8
S19-10-010	cross-pin bonescrew, selftapping	10
S19-10-012	cross-pin bonescrew, selftapping	12
S19-10-014	cross-pin bonescrew, selftapping	14
S19-10-016	cross-pin bonescrew, selftapping	16
S19-10-018	cross-pin bonescrew, selftapping	18

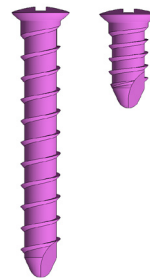

1.9 MM SCREW  
SELFTAPPING

Cat. No.	Description	Length
S22-10-004	cross-pin bonescrew, selftapping	4
S22-10-005	cross-pin bonescrew, selftapping	5
S22-10-006	cross-pin bonescrew, selftapping	6
S22-10-008	cross-pin bonescrew, selftapping	8
S22-10-010	cross-pin bonescrew, selftapping	10
S22-10-012	cross-pin bonescrew, selftapping	12
S22-10-014	cross-pin bonescrew, selftapping	14
S22-10-016	cross-pin bonescrew, selftapping	16
S22-10-018	cross-pin bonescrew, selftapping	18

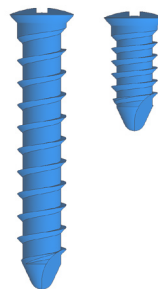

2.2 MM SCREW  
SELFTAPPING

Cat. No.	Description	Length
S16-20-004	cross-pin bonescrew, selfdrilling	4
S16-20-005	cross-pin bonescrew, selfdrilling	5
S16-20-006	cross-pin bonescrew, selfdrilling	6



1.6 MM SCREW  
SELFDILLING

Cat. No.	Description	Length
S19-20-004	cross-pin bonescrew, selfdrilling	4
S19-20-005	cross-pin bonescrew, selfdrilling	5
S19-20-006	cross-pin bonescrew, selfdrilling	6

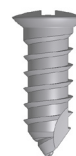

1.9 MM SCREW  
SELFDILLING



## BETA System - Orthognatic Surgery

### INSTRUMENTS



#### PLATE BENDING



IT01-102

IT01-103

Cat. No.	Description
IT01-102	90° bending tool, 12.5 cm
IT01-103	Plate bending pliers

#### PLATE CUTTING



IT02-200

IT02-201

Cat. No.	Description
IT02-200	Plate cutting plier, strong
IT02-201	Plate cutting scissor, inox, 16 cm

#### SCREWDRIVER



IT03-302

Cat. No.	Description
IT03-302	Screwdriver ALFA-BETA



# BETA System - Orthognatic Surgery

## INSTRUMENTS



### FORCEPS



IT04-400



IT04-401

Cat. No.	Description
IT04-400	Plate holding forceps, straight
IT04-401	Plate holding forceps, angled



IT05-502

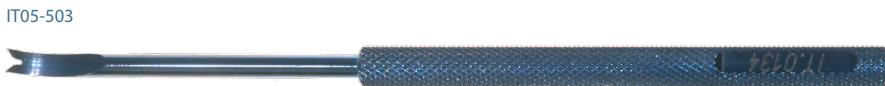

IT05-503

IT05-134

Cat. No.	Description
IT05-502	Plate holding device beta
IT05-503	Plate holding device beta, angled
IT05-134	Asc. ramus positioning tool (pusher)

### POSITIONING



IT07-700

Cat. No.	Description
IT07-700	Transbuccal system BETA

### TROCAR



## BETA System - Orthognatic Surgery

### INSTRUMENTS



BOX

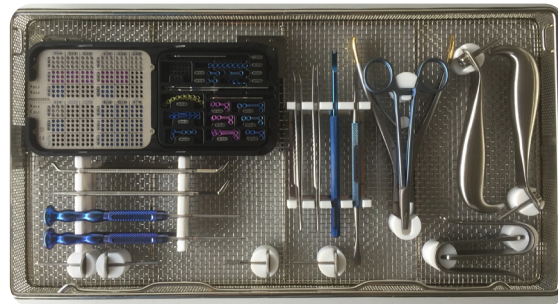

IT10-301 Organiser for BETA system

IT10-301	Cat. No.	Description	System	Max. quantity
↘	IT01-103	Plate bending pliers	Beta	2
↘	IT02-200	Plate cutting plier, strong	Beta	1
↘	IT03-302	Screwdriver ALFA-BETA	Beta	2
↘	IT04-400	Plate holding forceps, straight	Beta	1
↘	IT04-401	Plate holding forceps, angled	Beta	1
↘	IT05-134	Asc. ramus positioning tool (pusher)	Beta	1
↘	IT05-502	Plate holding device beta	Beta	1
↘	IT05-503	Plate holding device beta, angled	Beta	1
↘	IT06-600	Depth gauge	Beta	1
↘	IT07-700	Transbuccal system BETA	Beta	2
↘	Twist drills	To own preferences BETA	Beta	-
↘	Implants	To own preferences BETA	Alfa / Beta	-

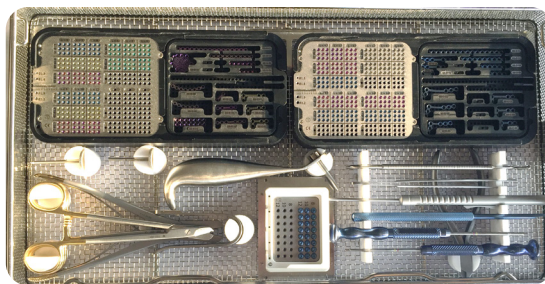

IT10-304 Organiser for ALFA-BETA system

IT10-304	Cat. No.	Description	System	Max. quantity
↘	IT01-103	Plate bending pliers	Alfa / Beta	2
↘	IT02-200	Plate cutting plier, strong	Beta	1
↘	IT02-201	Plate cutting scissor	Alfa / Beta	1
↘	IT03-302	Screwdriver ALFA-BETA	Alfa / Beta	2
↘	IT04-401	Plate holding forceps, angled	Alfa / Beta	1
↘	IT05-134	Asc. ramus positioning tool (pusher)	Beta	1
↘	IT05-503	Plate holding device beta, angled	Beta	1
↘	IT06-600	Depth gauge	Beta	1
↘	IT07-700	Transbuccal System BETA	Beta	1
↘	Twist drills	To own preferences ALFA and BETA	Beta	-
↘	Implants	To own preferences ALFA and BETA	Beta	-

## BETA System - Orthognatic Surgery

### TWIST DRILLS



### TWIST DRILL



Cat. No.	Description
IT115005	Twist drill, Ø1.1 mm, L=50 mm, stop 5 mm
IT115007	Twist drill, Ø1.1 mm, L=50 mm, stop 7 mm



Cat. No.	Description
IT126000	Twist drill, Ø1.2 mm, L=60 mm, without stop



Cat. No.	Description
IT135005	Twist drill, Ø1.3 mm, L=50 mm, stop 5 mm
IT135007	Twist drill, Ø1.3 mm, L=50 mm, stop 7 mm



Cat. No.	Description
IT145005	Twist drill, Ø0.4 mm, L=50 mm, stop 5 mm
IT145007	Twist drill, Ø1.4 mm, L=50 mm, stop 7 mm
IT146000	Twist drill, Ø1.4 mm, L=60 mm, without stop
IT149500	Twist drill, Ø1.4 mm, L=95 mm, without stop



Cat. No.	Description
IT186000	Twist drill transbuccal, Ø1.8 mm, L=60 mm, without stop
IT189500	Twist drill transbuccal, Ø1.8 mm, L=95 mm, without stop



Cat. No.	Description
IT192513	Twist drill, Ø1.9 mm, L=25 mm, stop 13 mm



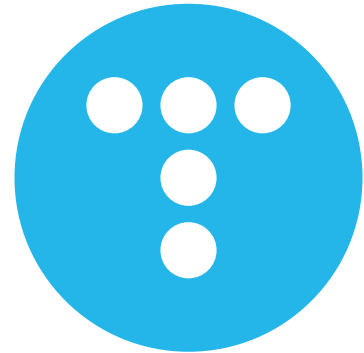

Headquarters:

Titamed  
Mechelsesteenweg 315 G  
2550 Kontich  
Belgium

tel: +32 (0)3 289 51 56  
email: [info@titamed.be](mailto:info@titamed.be)  
website: [www.titamed.com](http://www.titamed.com)

SP-603 Rev. A

